

MARK	DESCRIPTION	DATE	APP

NO.	DATE	TITLE
1501-1	SHT 1	DECK HOUSE ADDITIONS
1501-1	SHT 2	DECK HOUSE ADDITIONS
P-3		POTABLE & SANITARY WATER PIPING
P-5		SEWAGE SYSTEM OVERBOARD DISCHARGES & DECK DRAINS

GENERAL NOTES

1. ALL HOT & COLD SANITARY WATER PIPING TO BE INSULATED PER MECHANICAL CODE. USE OF CHLORIDE FREE & POTABLE.
2. ALL PIPING TO RUN TO EXISTING DECK UNLESS INDICATED OTHERWISE.
3. ALL SANITARY WATER DRAINS TO BE APPROXIMATE BUTYL-STRONG (ABS) TYPE (SEE MECHANICAL CODE).
4. ALL PIPING TO BE PROTECTED BY A MINIMUM OF 1/2" INSULATION.
5. ALL FITTINGS FOR SANITARY WATER DRAINS TO BE (ABS).
6. ALL SANITARY WATER DRAINS SHALL BE INSULATED.
7. ALL PIPING AND VALVES SHALL BE MARKED SHOWN ITS SERVICE AND PARTICULAR LIQUID.
8. ALL PIPING SHALL BE COLOR CODED IN ACCORDANCE WITH THE NATIONAL COLOR CODE AND SHALL INDICATE DIRECTION OF FLOW.
9. ALL LABELING SHALL BE ENGRAVED AND ATTACHED TO PIPING.
10. ALL PIPES SUBJECT TO MECHANICAL INJURY OR VIBRATION SHALL BE PROPERLY PROTECTED AND/OR SUPPORTED.
11. PIPING SHALL BE PROPERLY CLEANED AFTER INSTALLATION.
12. ALL PIPING SHALL BE PROTECTED BY A MINIMUM OF 1/2" INSULATION.
13. ALL WATER CLOSET DRAINS TO BE VENTED.
14. ALL SANITARY PIPING TO BE INSULATED 40 PIPE.

ALTER MARINE HULL-375
AGOR-21

Schuller & Allan, Inc.
MARINE ARCHITECTS & ENGINEERS
HOUSTON, TEXAS

TEXAS A 4 M
OCEAN RESEARCH VESSEL GYRE
DECK HOUSE P.W. &
SANITARY WATER PIPING

DRAWN BY BS
CHECKED BY JPB
APPROVED DATE 12/17/77
SCALE
DWG. NO. 1501-PI
ALT. 0

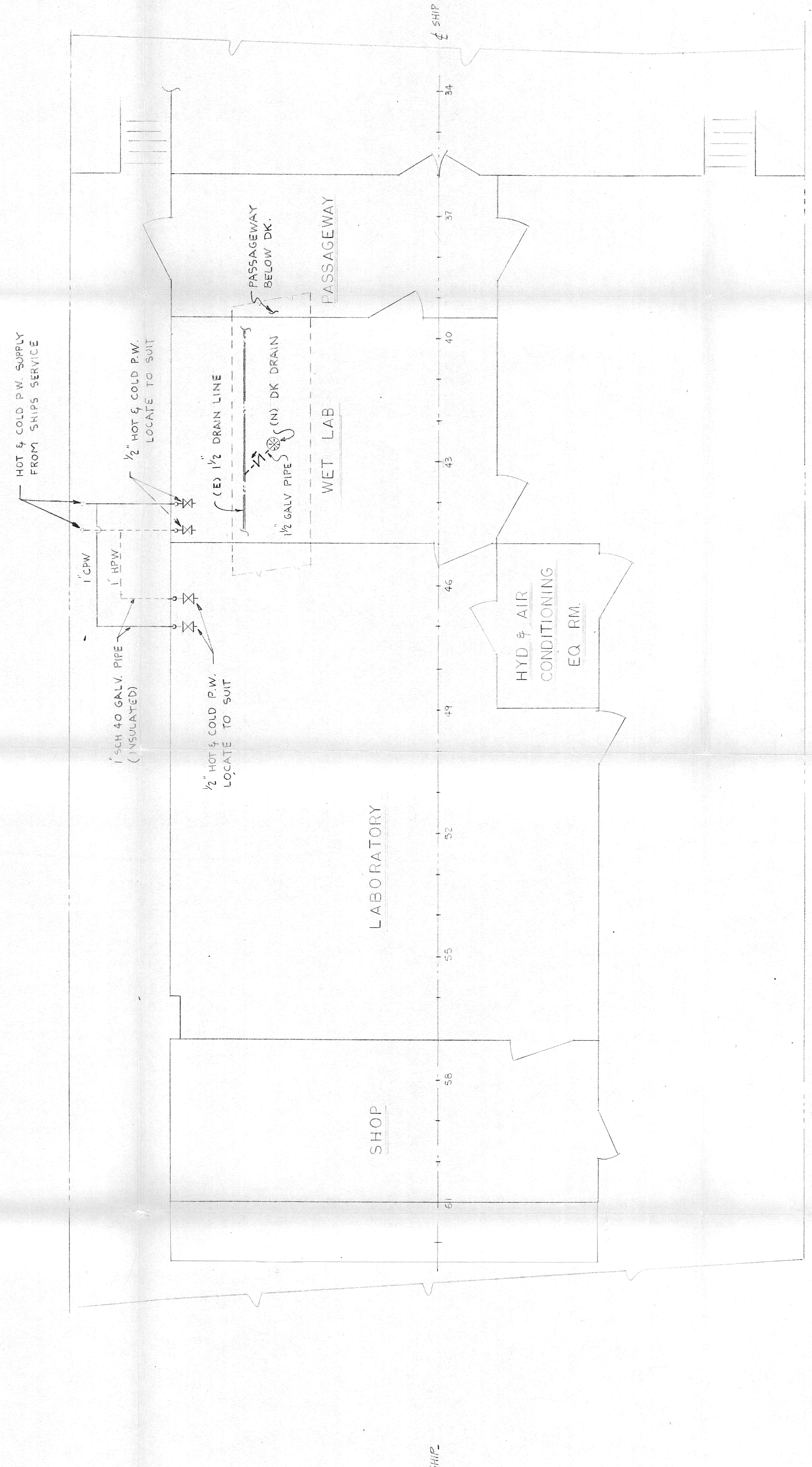

PLAN AT MAIN DECK

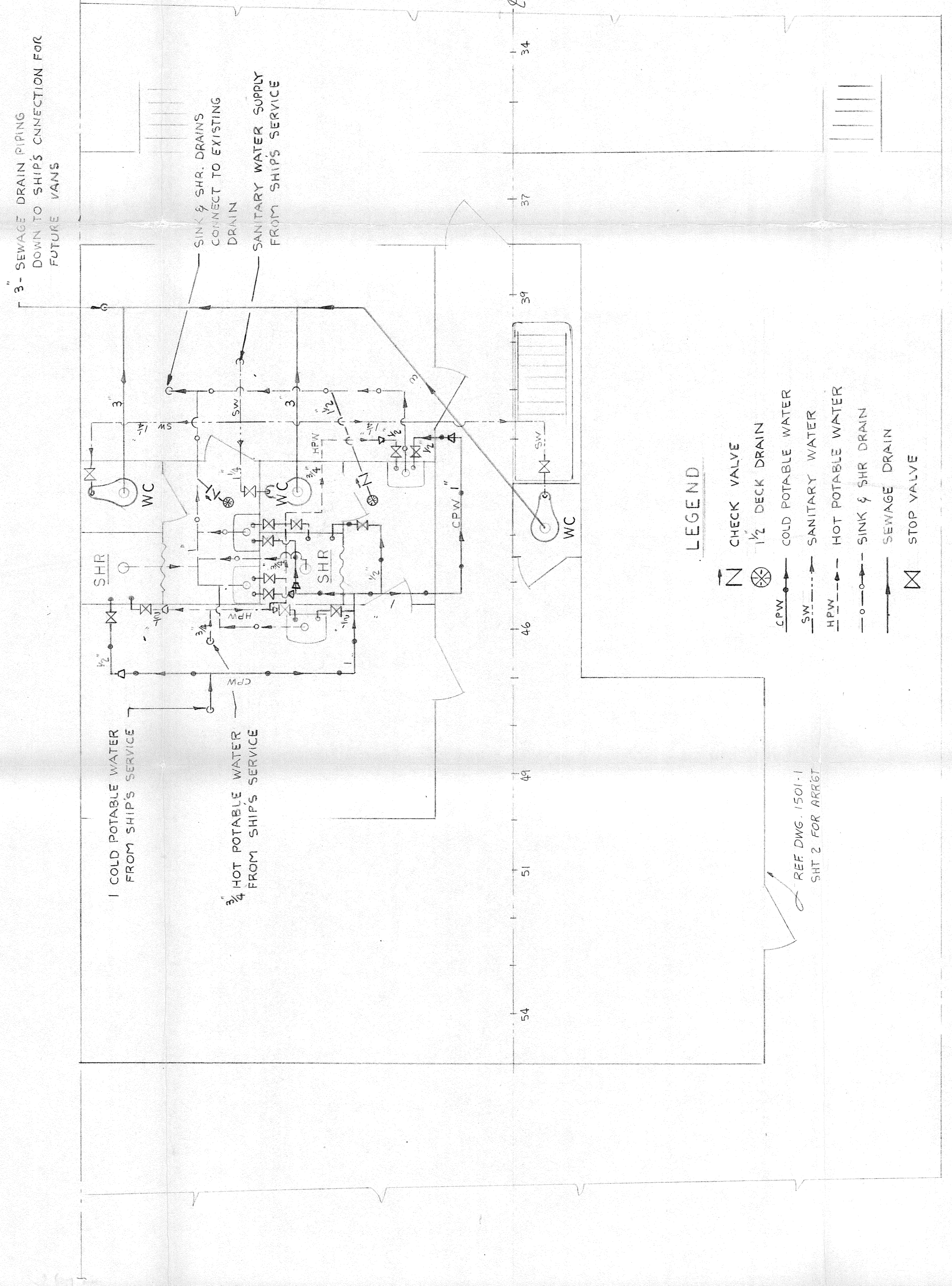

- ### LEGEND
- ⊘ CHECK VALVE
 - ⊖ 1/2" DECK DRAIN
 - CPW → COLD POTABLE WATER
 - HPW → HOT POTABLE WATER
 - SHR → SINK & SHR DRAIN
 - SW → SEWAGE DRAIN
 - ⊘ STOP VALVE

PLAN AT SECOND DECK

NOTE: SEE G.N. 14 FOR FURTHER INFORMATION NOT SHOWN IN MATERIAL SPEC.

SERVICE	MATERIAL SPECIFICATIONS			
	PIPE	TAKE-DOWN JOINTS	BODY VALVES	TRIM FITTINGS
ALL HOT, COLD, SANITARY PIPING	UNSCHEDULED POLYPROPYLENE (PP) SUITABLE FOR HOT & COLD WATER SERVICE. AT BHD. PENETRATIONS, SCH. 40 SMLS. GALV PIPE TO BE USED.	150" M.I. SCRD. GRD. W/ UNION BONNET A.S.T.M. A-197 & CPVC.	125" BRONZE SCRD. W/ UNION BONNET A.S.T.M. B-62	SCRD. IRON FITTINGS A-197 & CPVC.
SANITARY WATER DRAIN PIPING	ACRYLONITRILE BUTADIENE STYRENE (ABS) PIPE AT BHD. PENETRATIONS, SCH. 40 SMLS. GALV PIPE TO BE USED.	2 1/2" & OVER 150" F.S. SC. FLG. GALV. VALVE BRZ. SOLD. A.S.T.M. A-197 & CPVC. UNDER TO BE 150" M.I. SCRD. GRD. J.T. A-197 & ABS.	125" SWING CHECK VALVE BRZ. SOLD. A.S.T.M. B-62	2 1/2" & OVER STEEL BM. A.S.T.M. A-234, SCRD. IRON UNDER GALV. 150" A.S.T.M. A-197 & ABS.